

1. Parish Hall Entrance Gates re-located

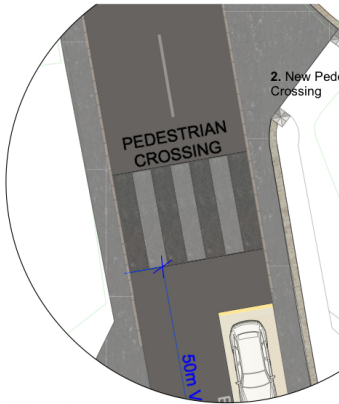

2. Pedestrian Crossing on St Saviour's Hill

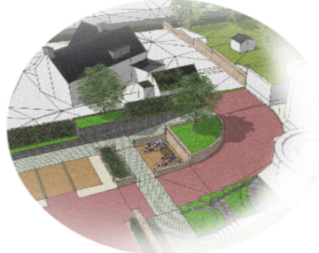
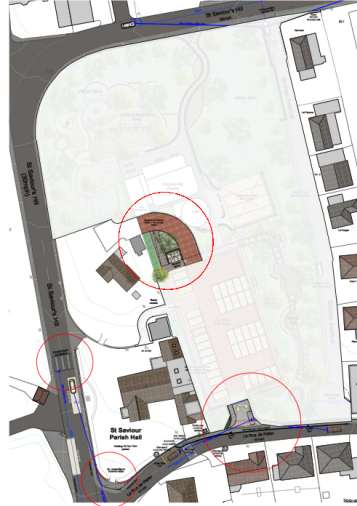
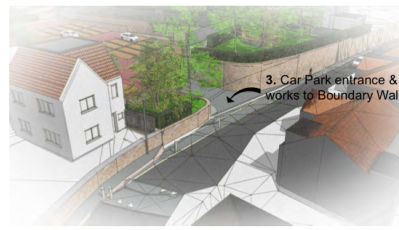
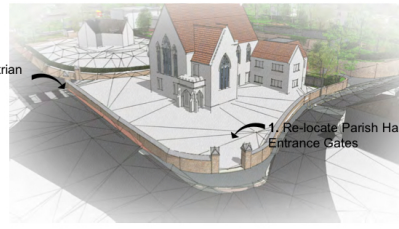

9. Extinguish existing access and creating new access to St. Saviour House.

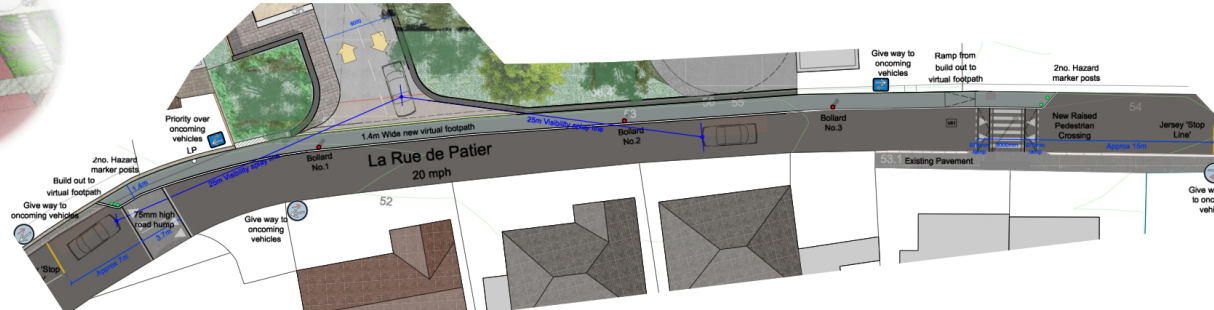
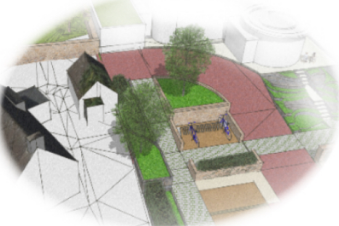

3. Car Park entrance & associated works to Boundary Wall
4. Virtual Footpath on La Rue de Patier

Proposed Works: Phase 1
1. Parish Hall Entrance Gates re-located
2. Pedestrian Crossing on St Saviour's Hill
3. Car Park entrance & associated works to Boundary Wall
4. Virtual Footpath on La Rue de Patier
5. New 40 space Car Park + Retaining Wall
6. Bicycle Store
7. Ramp Access from Parish Hall
8. Children Play / Park Area
9. Extinguish existing access and creating new access to St. Saviour House

PROPOSED WORKS (PHASE 1)

Scale 1:200